

KV 50

MULTISTAGE CENTRIFUGAL PUMPS WITH VERTICAL AXIS



CIVIL AND INDUSTRIAL PRESSURIZATION UNITS

Discharge and suction bodies, motor support and diffuser bodies in cast iron treated against corrosion.
 Technopolymer impellers and diffusers for KV32. Bronze impellers and cast iron diffusers for KV40 and KV50.
 Stainless steel shaft with sliding bush. Self lubricated bronze sliding bush guide.
 Carbon/tungsten carbide mechanical seal.
 Driving shaft - pump shaft coupling with a rigid fitting.
 Asynchronous, two- and four-poles motor closed and cooled by external ventilation.
 The user must provide overload protection.
 Supplied with threaded counter flanges as a standard feature.

Protection level: IP 55
Insulation class: F
Operating range:
 from 4 to 45 m³/h with head up to 265,5 metres.
Liquid temperature range: from -15°C to +110°C
Pumped liquid characteristics: clean, free from solids or abrasive substances, not viscous, not aggressive, not crystallised and chemically neutral.
Maximum ambient temperature: +40°C
Maximum working pressure:
 25 bar (2500 kPa) for KV32 - KV 40
 30 bar (3000 kPa) for KV50
Installation: permanent in a vertical position.

KV 50 - 2 POLES

MODEL	CODE	ELECTRICAL DATA			HYDRAULIC DATA													
		VOLTAGE 50 Hz	P2 NOMINAL		In A	Q=m ³ /h	10,2	12	13,8	15	18	21	24	27	30	36	42	45
			kW	HP		Q=l/min	170	200	230	250	300	350	400	450	500	600	700	750
KV 50/2 T	60144739	3 x 400 V ~ (1)	7,4	10	15	59	53,4	52,5	52	50,8	49,2	47,6	45,6	43,6	38,2	31	26,4	
KV 50/3 T	60144740	3 x 400 V ~ (1)	9,2	12,5	18	88,5	80,1	79	78	76,2	73,8	71,4	68,4	65,4	57,3	46,5	39,6	
KV 50/4 T	60144741	3 x 400 V ~ (1)	11	15	22	118	106,8	105	104	101,6	98,4	95,2	91,2	87,2	76,4	62	52,8	
KV 50/5 T	60144742	3 x 400 V ~ (1)	14,7	20	30	147,5	133,5	131	130	127	123	119	114	109	95,5	77,5	66	
KV 50/6 T	60144743	3 x 400 V ~ (1)	18,4	25	36	177	160,2	15,8	156	152,4	147,6	142,8	136,8	130,8	114,6	93	79,2	
KV 50/7 T	60144744	3 x 400 V ~ (1)	22	30	40	206,5	186,9	184	182	177,8	172,2	166,6	159,6	152,6	133,7	108,5	92,4	
KV 50/8 T	60144745	3 x 400 V ~ (1)	22	30	40	236	213,6	212	208	203,2	196,8	190,4	182,4	174,4	152,8	124	105,6	
KV 50/9 T	60144746	3 x 400 V ~ (1)	29,4	40	56	265,5	240,3	238	234	228,6	221,4	214,2	205,2	196,2	171,9	139,5	118,8	

(1) Star starting is possible (λ)

KV 50 - 4 POLES

MODEL	CODE	ELECTRICAL DATA			HYDRAULIC DATA												
		VOLTAGE 50 Hz	P2 NOMINAL		Q=m ³ /h	0	1,5	3	4,5	6	7,5	9	10,5	12	18	21	
			kW	HP	Q=l/min	0	25	50	75	100	125	150	200	250	300	350	
KV 50/34 T	60144747	3 x 230 - 400 V ~	1,1	1,5	22,5	22	21,5	21	20,5	20	19	17,5	16	14	11,5		
KV 50/44 T	60144748	3 x 230 - 400 V ~	1,5	2	30	29,5	28,5	28	27	26,5	25,5	23,5	21	18,5	15,5		
KV 50/54 T	60144749	3 x 230 - 400 V ~	2,2	3	37	36,5	36	35	34	33	32	29,5	26,5	23	19		
KV 50/64 T	60144750	3 x 230 - 400 V ~	2,2	3	45	44,4	43,5	42	41	40	38,5	35,5	32	28	23		
KV 50/74 T	60144751	3 x 230 - 400 V ~	3	4	52	51,5	50,5	49,5	48	46,5	45	41,5	37,5	32,5	26,5		
KV 50/84 T	60144752	3 x 230 - 400 V ~	3	4	60	59	57,5	56,5	54,5	53	51,5	47,5	42,5	37	30,5		
KV 50/94 T	60144753	3 x 230 - 400 V ~	4	5,5	67,5	66	64,5	63	61,5	60	58	53,5	48	42	34,5		
KV 50/104 T	60144754	3 x 230 - 400 V ~	4	5,5	75	73,5	72	70	68,5	66,5	64	59	53,5	46,5	38		
KV 50/114 T	60144755	3 x 230 - 400 V ~	4	5,5	82	81	79	77	75	72,5	70	65	58,5	51	42		
KV 50/124 T	60144756	3 x 400 V ~ (1)	5,5	7,5	90	88	86	84	82	79,5	77	71	64	56	46		
KV 50/134 T	60144757	3 x 400 V ~ (1)	5,5	7,5	97,5	95,5	93	91	88	85,5	82,5	76,5	69	61	50		
KV 50/144 T	60144758	3 x 400 V ~ (1)	5,5	7,5	105	103	100,5	97,5	95	92	89	82	74	65	53,5		
KV 50/154 T	60144759	3 x 400 V ~ (1)	5,5	7,5	112,5	110	107,5	105	102	99	95,5	88,5	80	70	57,5		

(1) Star starting is possible (λ)

KV 50

MULTISTAGE CENTRIFUGAL PUMPS WITH VERTICAL AXIS

KV 50 2 POLES (2900 1/min)

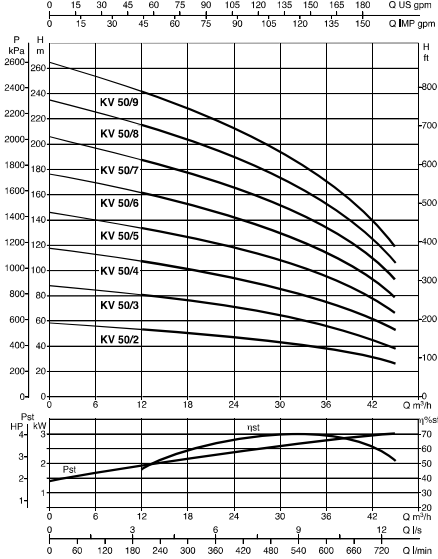

KV 50 4 POLIES (1450 1/min)

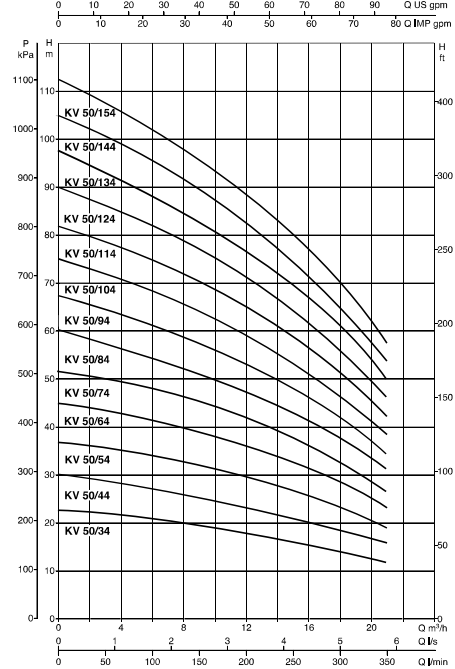

DIMENSIONS

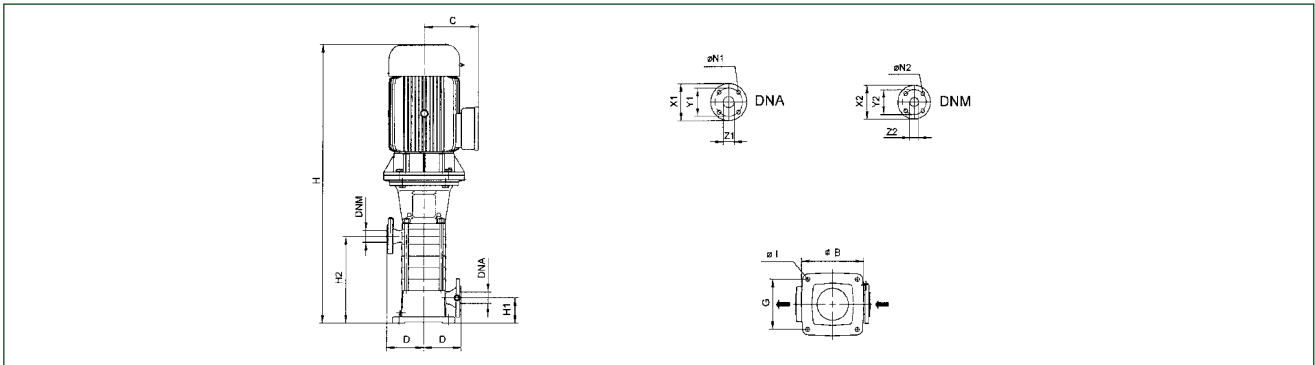

2 POLES

MODEL	B	C	D	G	∅	H	H1	H2	DNA	DNM	WEIGHT Kg
KV 50/2 T	338	191	185	265	18	949	144	280	65	50	135
KV 50/3 T	338	191	185	265	18	1003	144	334	65	50	149
KV 50/4 T	338	191	185	265	18	1094	144	388	65	50	177
KV 50/5 T	338	234	185	265	18	1298	144	442	65	50	229
KV 50/6 T	338	234	185	265	18	1352	144	496	65	50	242
KV 50/7 T	338	234	185	265	18	1406	144	550	65	50	263
KV 50/8 T	338	234	185	265	18	1460	144	604	65	50	270
KV 50/9 T	338	280	185	265	18	1600	144	658	65	50	406

4 POLES

MODEL	H1	B	C	D	G	I	FLANGE DIMENSION DNA*				FLANGE DIMENSION DNm*			
							X1	Y1	Z1	N1	X2	Y2	Z2	N2
KV 50/...	144	338	185	185	265	18	185	145	65	18	165	125	50	18

*Flanges of 2 and 4 poles have the same dimensions.